

Dimensional Data

SL Service Body

Model	Approx. Wt. Steel	Cab-to-Axle	A	B	C	D	Approximate Compartment Clear Door Openings					J	K	L	M
							E	F	G	H	I				
U98AQ-SW	1023 lbs.	56"	76-1/2"	48-1/2"	14"	-	22-1/2" x 35-1/4"	46-1/2" x 14"	16-1/2" x 35-1/4"	-	-	28"	48"	22"	98"
U108AQ-DW	1359 lbs.	60"	93"	50"	21-1/2"	-	29-1/4" x 35-1/4"	45-1/2" x 14"	20-3/4" x 35-1/4"	-	-	34-3/4"	47"	26-1/4"	108"
U132AQ-DW	1832 lbs.	84"	92"	50"	21-1/2"	26"	22-1/2" x 35-1/4"	48-1/4" x 14"	20-3/4" x 35-1/4"	35" x 35-1/4"	11-1/2" x 35-1/4"	30"	49-3/4"	26-1/4"	132"

Models U98AQ-SW, U108AQ-DW

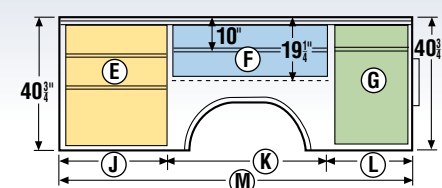

Compartment configuration same on both sides

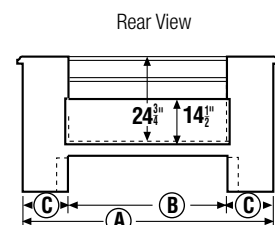

Models U132AQ-DW

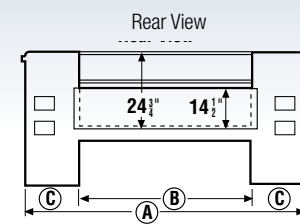
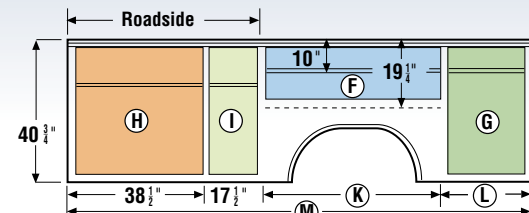

50" clear floor width - no wheel boxes

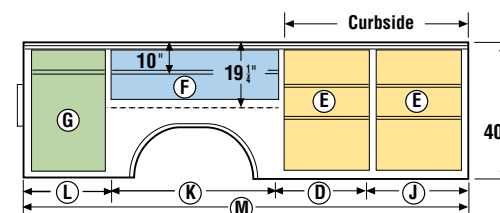

NOTE: U98A-SW not available for mounting on Dodge chassis

Shelves and dividers: U98AQ-SW: (8) shelves, (32) dividers; U108AQ-DW: (8) shelves, (40) dividers; U132AQ-DW: (9) shelves, (40) dividers

NOTE: Divider spacing on 2" centers

Hybrid Aluminum Service Body

Model	Approx. Weight	Cab-to-Axle	A	B	C	D	Approximate Compartment Clear Door Openings			J	K	L	M
							E	F	G				
98-SW	668 lbs.	56"	28"	48"	22"	98"	22-1/2" x 35-1/4"	46-1/2" x 14"	16-1/2" x 35-1/4"	-	-	-	-
108-DW	751 lbs.	60"	93"	50"	21 1/2"	-	29-1/4" x 35-1/4"	45-1/2" x 14"	20-3/4" x 35-1/4"	34 x 3/4"	47"	26-1/4"	108"

Model 98-Single Wheel

Curbside and Roadside Compartment Layout

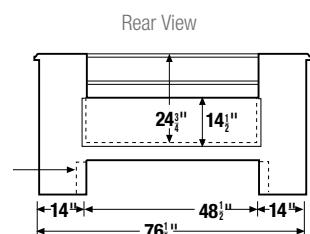

Model 108-Dual Wheel

Curbside and Roadside Compartment Layout

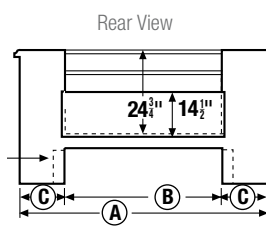
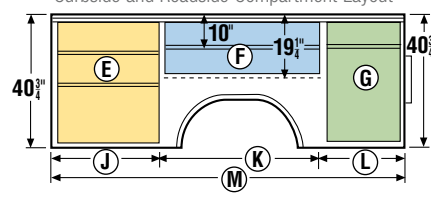

Standard shelf and divider equipment

All shelves removable, all dividers removable and adjustable. Dividers interchangeable on most shelves. (8) shelves: 98, & 108 models. (32) dividers: 98 models. (40) dividers: 108 models

The Reading Group has a full line of trucks built for the long haul.



SL Service Body & Classic Hybrid ALUMINUM SERVICE BODY

Expect More Standard Features!



Shown with optional equipment



Shown with optional equipment



TheReadingGroup.us

Locations	Cleveland, OH	LaGrange, TX	Reading, PA
Abington, PA	Clinton, MD	Louisville, KY	Seneca, PA
Atlanta, GA	Columbus, OH	Pontiac, MI	Suffolk, VA
Bowmansville, PA	Denver, PA	Portland, OR	Tampa, FL

All dimensions subject to plus or minus tolerance of 1/4" and all dimensions and specifications are subject to change without notice. Some items displayed in photographs are optional. Alum-Fil, Alum-Check, Dual-Pro, Extend-A-Shelf, Grip-In-Glide, Latch-Matic, Marauder, Reading, Redi-Dek, Rhino Linings, Rugged American, S.M.A.R.T. Racks, Spacesaver, Tool-Mates, and TUFF-STUFF are registered trademarks of The Reading Group, LLC in the United States and some foreign countries. The Reading kangaroo is a trademarked image and may not be reproduced or used without express permission from The Reading Group. TRG10-HYSL-15M-06 © 2010 The Reading Group, LLC

SOLD AND SERVICED LOCALLY BY

RUGGED | DURABLE | DEPENDABLE | VERSATILE

- STAINLESS steel bolt on hinges - SL Body
- HIDDEN hinges - Classic Hybrid
- LEGENDARY quality and durability
- TIMELESS design, maximized for efficiency



Classic Hybrid Aluminum Service Bodies

The Classic Hybrid body is assembled utilizing advanced technology. This unique, fully tested process combines the corrosion resistance of rugged, weight savings aluminum body side packs with the toughness of two-sided galvanized steel diamond plate floor (patent pending) and understructure joined with multiple grade 8 stainless steel hardened fasteners. A barrier at joints prevents corrosion.

The C2-50 Options Package

This Hybrid is equipped with the C2-50 Options Package, a group of our most popular and most exclusive options. C2-50 includes:



- Latch-Matic® remote locking system with audible alarm

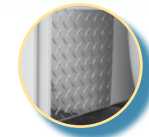

- Bright finish aluminum treadplate guards on front of body panels and on top of tailgate



- Compartment and cargo area lighting system activated by the key fob



- Extend-A-Shelf™ modular drawer unit provides easy installation and removal

Individual items from this package can be purchased separately



NEW Advanced Technology.



Shown with options



SL Service Bodies

VALUE AND ECONOMY... Utilizing patent pending modular production techniques, the SL offers an impressive list of traditional Reading standard features, yet is priced far lower than expected. It's yet another reason why you can Expect More when you Choose Reading!

SL Options



SL Standard Line Body with Optional Aluminum Spacemaker Lids includes:

- Aluminum textured spacemaker lids with clear Powder Coat protective finish
- Stainless steel 3-point T-handle locks



Manufactured With Confidence

Service Bodies

Hybrid Features



Rotary Master Locking System Stainless steel handle mounted on each rear compartment. This locks all compartments simultaneously for additional security



Overlapping Door Construction An industry exclusive that resists forcible entry. The robust, patented hidden hinge design provides protection against corrosion and does not require maintenance or frequent lubrication



Complete Stainless Steel Rotary Locks Have an attractive appearance and are rust resistant. Feature a double bitting, high quality locking cylinder, adjustable striker pins and an O-ring seal to prevent water intrusion

Hybrid & SL Features



Pooched Bumper White Powder Coated steel. Pooched design provides slip resistant step surface



Slam Action Tailgate Features a polished, stainless steel handle and double-panel construction. Stainless steel locking rods, hinge rods, and striker channels



Removable Stainless Steel Tailgate Knee Brace Protects against rust and corrosion while allowing the tailgate to swing down completely



Rectangular L.E.D. Tail Lights Provides modern look and are leak resistant

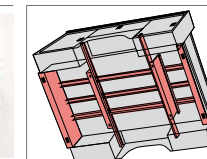

Rugged Classic II Understructure Fully unitized welding, with U-beam girders braced and reinforced at all critical points. Acrylic E-Coat primed and coated with a tough, water-based undercoating that meets all environmental standards



A40-A60 Coating Weight Pressed Steel Diamond Plate Floor and Tailgate Inner Panel Industry exclusive A40-A60 coating weight steel diamond plate surface provides additional corrosion protection and better traction. Patent pending



Thick Heavy-Duty Aluminum Compartment Doors Feature heavy-duty aluminum skins with internal reinforced, double-paneled construction



Seamless Wheelhouse Panel gives dirt and moisture fewer places to collect



Aluma-fill® Protects body from accidental nicks and scratches during fueling



Nitrogen Strut Door Holders Equipped on all vertical doors. Doors feature internal dampeners that enhance door operation and provide superior performance over spring-loaded door holders

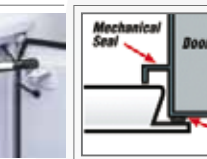

Exclusive Dual-Pro® Seal System for compartment doors provides a dual line of defense against the elements. Features automotive-like quality bubble type seals and a mechanical seal

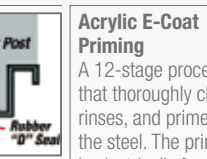

Acrylic E-Coat Priming A 12-stage process that thoroughly cleans, rinses, and primes the steel. The primer is electrically fused to the steel, providing complete coverage to the understructure

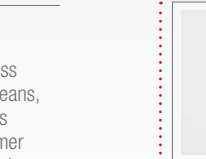

Stainless Steel Bolt-On Hinges feature a fully concealed pin, protected from the elements and providing smooth, reliable operation



Also Available With Complete Stainless Steel Rotary Locks on 98" length only Optional Latch-Matic remote locking system available with rotary locks only



Shown With Compartments with T-handle Locks and Hidden Fasteners Featuring pass through opening between horizontal and rear vertical compartments for long objects. Body sides are two-sided, zinc coated steel, and both have white Powder Coat finish



Stainless Steel Bolt-On Hinges feature a fully concealed pin, protected from the elements and providing smooth, reliable operation

SL Features